

CRESSWIND PALM BEACH PHASE 2

BEING A PORTION OF SECTION 6, TOWNSHIP 43 SOUTH, RANGE 41 EAST,
AND SECTIONS 1 AND 12, TOWNSHIP 43 SOUTH, RANGE 40 EAST,
CITY OF WESTLAKE, PALM BEACH COUNTY FLORIDA

THIS INSTRUMENT PREPARED BY
DAVID P. LINDLEY
OF
CAULFIELD and WHEELER, INC.
SURVEYORS — ENGINEERS — PLANNERS
7900 GLADES ROAD, SUITE 100
BOCA RATON, FLORIDA 33434 — (561)392-1991
CERTIFICATE OF AUTHORIZATION NO. LB3591

204

SHEET 6 OF 7

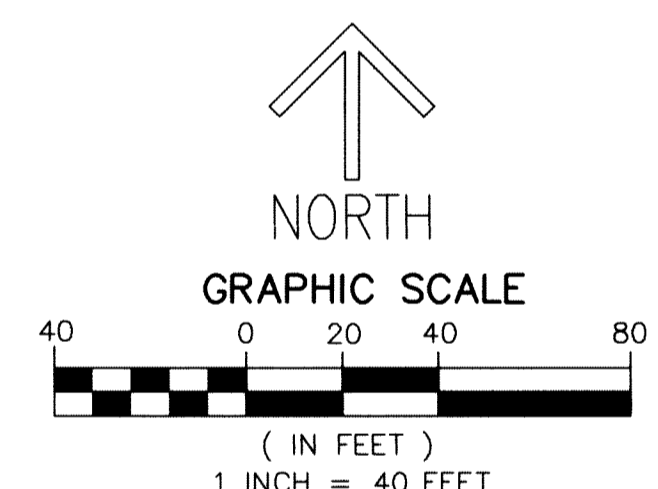
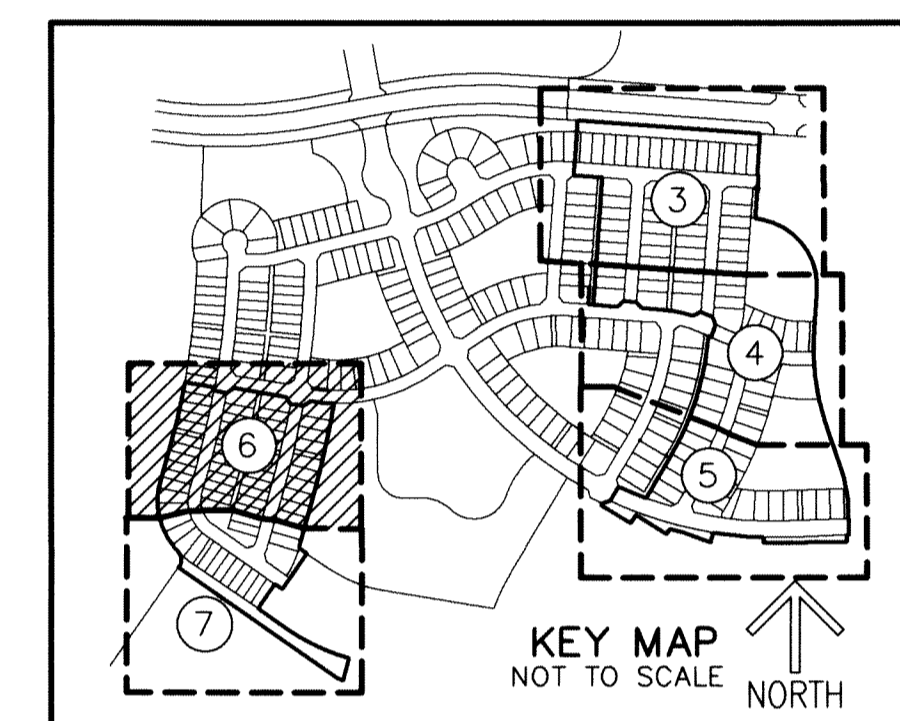

NOTES
COORDINATES, BEARINGS AND DISTANCES
COORDINATES SHOWN ARE GRID
DATUM = NAD 83 (2007 ADJUSTMENT)
ZONE = FLORIDA EAST
LINEAR UNIT = US SURVEY FEET
COORDINATE SYSTEM 1983 STATE PLANE
TRANSVERSE MERCATOR PROJECTION
ALL DISTANCES ARE GROUND
SCALE FACTOR = 1.0000017
GROUND DISTANCE X SCALE FACTOR = GRID DISTANCE
BEARINGS AS SHOWN HEREON ARE GRID DATUM,
NAD 83 (2007 ADJUSTMENT), FLORIDA EAST ZONE.

LEGEND/ABBREVIATIONS
 C — CENTERLINE
 Δ — DELTA (CENTRAL ANGLE)
 CB — CHORD BEARING
 CD — CHORD DISTANCE
 DE — DRAINAGE EASEMENT
 E — EASTING (WHEN USED WITH COORDINATES)
 L — ARC LENGTH
 LMAE — LAKE MAINTENANCE ACCESS EASEMENT
 LAE — LIMITED ACCESS EASEMENT
 LB — LICENSED BUSINESS
 N — NORTHING (WHEN USED WITH COORDINATES)
 (NR) — NON-RADIAL LINE
 O.S.T. — OPEN SPACE TRACT
 PC — POINT OF CURVATURE
 PT — POINT OF TANGENCY
 PNT — POINT OF NON-TANGENCY
 PRC — POINT OF REVERSE CURVATURE
 R — RADIUS
 RPE — RURAL PARKWAY EASEMENT
 U.E. — UTILITY EASEMENT
 ● — SET PERMANENT CONTROL POINT
 NAIL AND DISK STAMPED "C&W PRM LB3591"
 ● PRM — SET PERMANENT REFERENCE MONUMENT
 SET 5/8" IRON ROD WITH CAP
 STAMPED "C&W PRM LB3591"
 ■ PRM — FOUND PERMANENT REFERENCE MONUMENT
 4" x 4" x 24" CONCRETE MONUMENT WITH
 DISK STAMPED "PRM LB7768"